

- Application

3D Depth Sensor

TOF Sensor

IR Illumination

Etc.



- Merit

Narrow beam angle

Optical output power 200mW

MSL3 250°C peak reflow compatible

Thin Package t0.77mm

- Absolute Maximum Ratings

Parameter	Symbol	Ratings	Unit	
Continuous Forward Current	If (CW)	300	mA	(Ta=25°C)
Pulse Forward Current 100Hz Duty10% (on time 1ms)	If (Pulse)	500	mA	(Ta=25°C)
Reverse Voltage	Vr	5	V	(Ta=25°C)
Junction temp.	Tj	125	°C	
Solder reflow temp.	Tsr	250(10sec)	°C	
Operating temp.	Top	-20 to 70	°C	
Storage temp.	Tstg	-40 to 100	°C	

Condition : mounted on AL board with Heatsink

- Characteristics (Ta=25°C)

Parameter	Symbol	Conditions	MIN.	TYP.	MAX.	Unit
Threshold current	Ith	—	—	70	100	mA
Optical Power	Po	If=300mA (tp=800μsec)	140	200	260	mW
Forward voltage	Vf	If=300mA (tp=800μsec)	—	2.0	2.6	V
Beam divergence	FWHM	If=300mA (tp=800μsec)	—	13	—	deg
Conversion efficiency	PCE	If=300mA (tp=800μsec)	—	33	—	%
Slope efficiency	η	If (100mA to 300mA)	0.5	0.85	1.1	W/A
Peak Wavelength	λp	If=300mA (tp=800μsec)	930	940	950	nm
λ temp variation	Δλ/ΔT	—	—	0.07	—	nm/°C
ESD damage threshold	ESD HBM	Human Body Model	2000	—	—	V

Condition: Ta=25°C with Heatsink.

Caution: The data above is used as reference only, i.e. not specification guarantee. Specifications and data are subject to change without notice.

## ●Dimensions

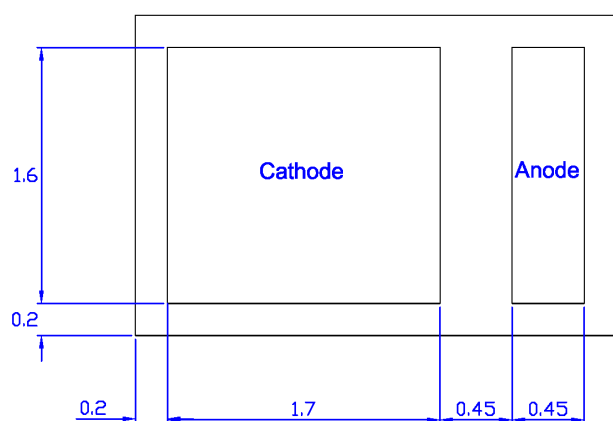
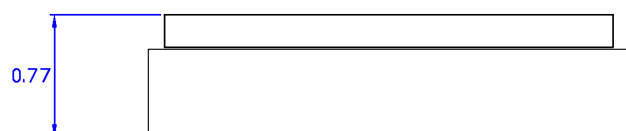
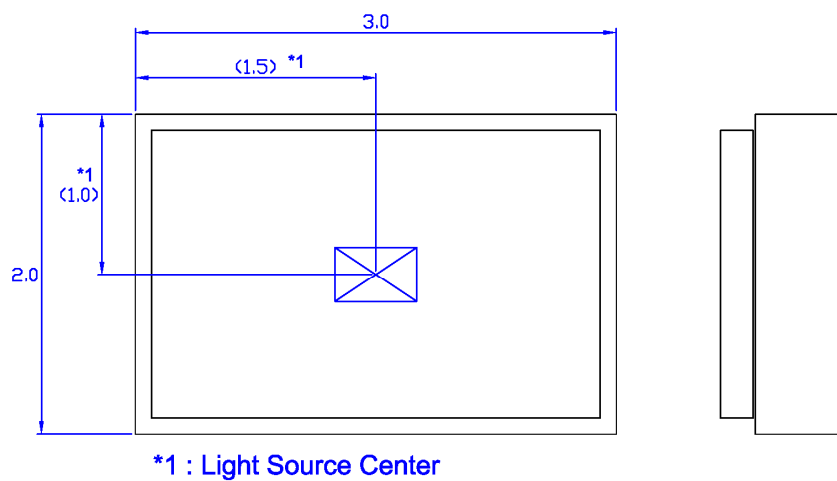

Unit : mm



### Note

- Unspecified tolerance shall be  $\pm 0.15\text{mm}$
- Dimensions do not include burrs  
(Max burr size  $+0.25\text{mm}$ )

## ●Beam Divergence Data

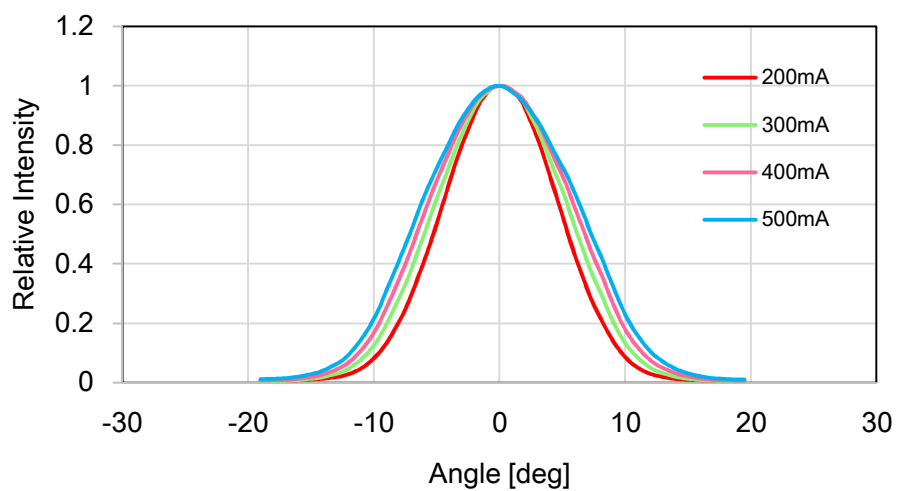

Condition : PKG individual piece , Pulse 50kHz Duty50% (on time 10us)

## Notes

- 1) The information contained herein is subject to change without notice.
- 2) Before you use our Products, please contact our sales representative and verify the latest specifications :
- 3) Although ROHM is continuously working to improve product reliability and quality, semiconductors can break down and malfunction due to various factors.  
Therefore, in order to prevent personal injury or fire arising from failure, please take safety measures such as complying with the derating characteristics, implementing redundant and fire prevention designs, and utilizing backups and fail-safe procedures. ROHM shall have no responsibility for any damages arising out of the use of our Products beyond the rating specified by ROHM.
- 4) Examples of application circuits, circuit constants and any other information contained herein are provided only to illustrate the standard usage and operations of the Products. The peripheral conditions must be taken into account when designing circuits for mass production.
- 5) The technical information specified herein is intended only to show the typical functions of and examples of application circuits for the Products. ROHM does not grant you, explicitly or implicitly, any license to use or exercise intellectual property or other rights held by ROHM or any other parties. ROHM shall have no responsibility whatsoever for any dispute arising out of the use of such technical information.
- 6) The Products are intended for use in general electronic equipment (i.e. AV/OA devices, communication, consumer systems, gaming/entertainment sets) as well as the applications indicated in this document.
- 7) The Products specified in this document are not designed to be radiation tolerant.
- 8) For use of our Products in applications requiring a high degree of reliability (as exemplified below), please contact and consult with a ROHM representative : transportation equipment (i.e. cars, ships, trains), primary communication equipment, traffic lights, fire/crime prevention, safety equipment, medical systems, servers, solar cells, and power transmission systems.
- 9) Do not use our Products in applications requiring extremely high reliability, such as aerospace equipment, nuclear power control systems, and submarine repeaters.
- 10) ROHM shall have no responsibility for any damages or injury arising from non-compliance with the recommended usage conditions and specifications contained herein.
- 11) ROHM has used reasonable care to ensure the accuracy of the information contained in this document. However, ROHM does not warrant that such information is error-free, and ROHM shall have no responsibility for any damages arising from any inaccuracy or misprint of such information.
- 12) Please use the Products in accordance with any applicable environmental laws and regulations, such as the RoHS Directive. For more details, including RoHS compatibility, please contact a ROHM sales office. ROHM shall have no responsibility for any damages or losses resulting from non-compliance with any applicable laws or regulations.
- 13) When providing our Products and technologies contained in this document to other countries, you must abide by the procedures and provisions stipulated in all applicable export laws and regulations, including without limitation the US Export Administration Regulations and the Foreign Exchange and Foreign Trade Act.
- 14) This document, in part or in whole, may not be reprinted or reproduced without prior consent of ROHM.



Thank you for your accessing to ROHM product informations.  
More detail product informations and catalogs are available, please contact us.

## ROHM Customer Support System

<http://www.rohm.com/contact/>